

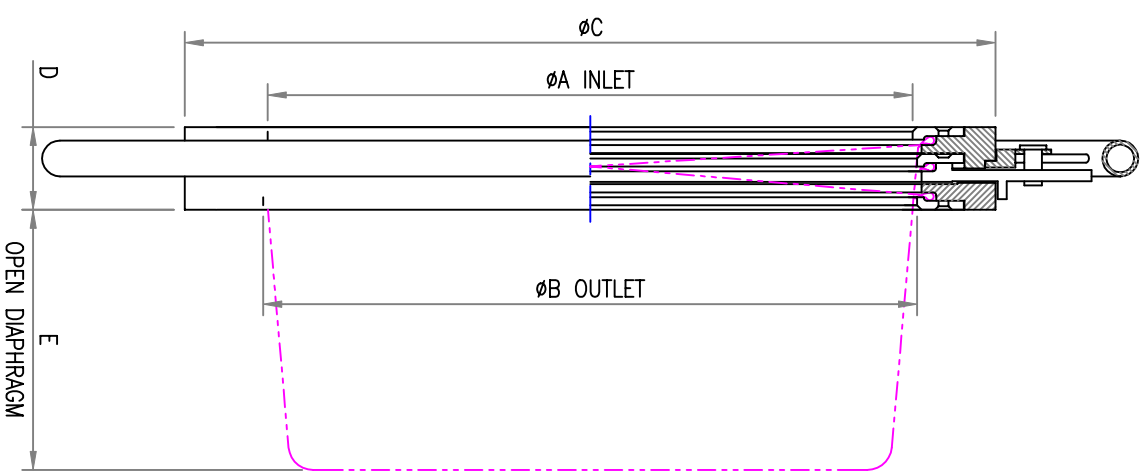

Mucon
The Power to Control Powders

| Valve Type | Norm Bore | All dimensions in mm / Weights given for All unit in kgs | | | | | | | | | | | | | Nett Weight |
|------------|-----------|--|-----|-----|----|-----|-----|---|-----|---|----|-----|--|------|-------------|
| | | A | B | C | D | E | F | G | H | J | K | L | | | |
| AD6 | 150 | 147 | 153 | 228 | 41 | 75 | 445 | 3 | M8 | 3 | 9 | 203 | | 3.1 | |
| AD8 | 200 | 198 | 204 | 280 | 41 | 102 | 445 | 3 | M8 | 3 | 9 | 254 | | 4.4 | |
| AD10 | 250 | 250 | 260 | 356 | 52 | 127 | 584 | 4 | M10 | 4 | 11 | 327 | | 8.7 | |
| AD12 | 300 | 300 | 310 | 406 | 52 | 152 | 584 | 4 | M10 | 4 | 11 | 378 | | 10.4 | |
| AD15 | 380 | 381 | 387 | 498 | 59 | 190 | 702 | 6 | M10 | 6 | 11 | 470 | | 19.1 | |
| AD18 | 450 | 457 | 464 | 575 | 59 | 228 | 778 | 6 | M10 | 6 | 11 | 546 | | 26.3 | |

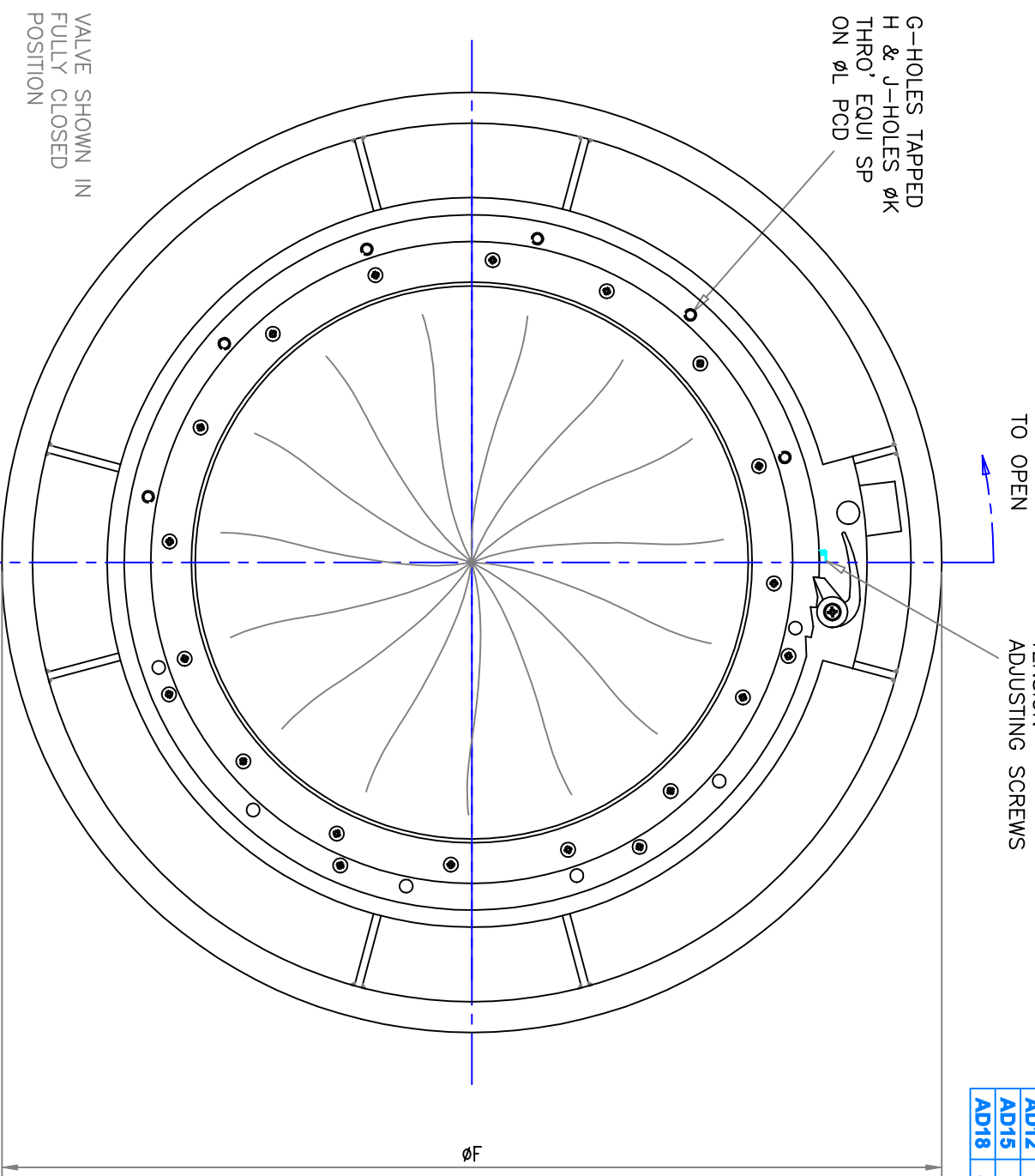

Series AD Handwheel Operated Iris Diaphragm Valve

Mucon Division, Kemutec Group, Springwood Way, Macclesfield, Cheshire, UK SK10 2ND, Tel: +44 (0)1625 412000, Fax: +44 (0)1625 412001

Although every effort is made to ensure this data is current, our products are subject to ongoing development and accordingly we reserve the right to change specifications and details without prior notice. Always request a certified drawing

05/07/00